

A group of four people are working on a shoreline. They are standing on a row of large, rectangular concrete blocks that form a barrier or structure in the water. The people are wearing casual work clothes, including hats and boots. In the background, there is a body of water and a residential area with houses and trees. The overall scene is dimly lit, suggesting dusk or dawn.

Living Shoreline Incentives, Business Opportunities, & Collaborative Practice

Beth Ginter

Executive Director, Chesapeake Conservation Landscaping Council

Shoreline Erosion Advisory Service

- Organization: Virginia Department of Conservation and Recreation
- What is Provided: free, unbiased technical assistance including site investigations, written advisory reports, design and plan reviews, construction inspections, and guidance on available financial incentive programs.
- Who Qualifies: private property owners (residential and agricultural), localities, and state and federal agencies experiencing shoreline or streambank erosion across Virginia
- Contact: Aaron Wendt
(804) 296-1701 or aaron.wendt@dcr.virginia.gov
<http://www.dcr.virginia.gov/soil-and-water/seas>



Opportunities: VCAP

Organization: Virginia Association of Soil and Water Conservation Districts; administered by individual districts

What is Provided: Financial reimbursement of 80% of the total costs, up to \$30,000

Who Qualifies: Public, private, non-profit, and commercial landowners within a participating district. Eligible shorelines must have no more than 1.5-mile fetch distances in any direction, and any structures onsite must be at least three years old

Contact: Your local district

Colonial: robyn.goad@colonialswcd.net, Northern Neck: lowery.becker@nnswwcd.org

Lower James SWCDs



Colonial SWCD: James City, Charles City

James River SWCD: Prince George

Peanut SWCD: Surry, Isle of Wight, Suffolk

Virginia Dare SWCD: Chesapeake, VA Beach

No District: Newport News, Hampton, Norfolk, Portsmouth

Virginia Agricultural Cost Share Program (VACS) used for Berkeley Plantation LS

Opportunities: Elizabeth River Project

Living Shorelines on the Elizabeth River

- **ERP is actively looking for subcontractors to construct living shorelines**
- Projects mostly designed & permitted by ERP, subcontractors needed for install
- Projects cost shared to ease cost burden on landowners – tell your clients!
- Contractors with all levels of training welcome – Shadow an installation, volunteer, become familiar with techniques
- Contact: Phoebe Murrell,
pmurrell@elizabethriver.org
757-861-1821



Opportunities: James River Assoc.

Living Shorelines on the Lower James

- **JRA is looking for contractors!**
- Living shorelines are designed and permitted by JRA staff.
- Need contractors to do installations and maintenance on existing projects!
- Grant funded cost-share program for homeowners
- We will send out an RFQ soon
- Contact: Ryan Walsh
- rwalsh@thejamesriver.org
- 757-703-0671



LRNow Living Shoreline Opportunities



Little Haven 2012



Little Haven 2014

- LRNow coordinates 1-3 residential living shorelines in Virginia Beach each year
- Subcontract for design and installation
- Funding assistance from VCAP, VBCAP
- Volunteer labor to further reduce cost to homeowners
- Contact: Vince Bowhers,
Vince@LRNow.org 757-773-1636

Opportunities: Middle Peninsula

[OWNERS](#) [CONTRACTORS](#) [GRANTS/LOANS](#) [ABOUT](#) [FIGHT THE FLOOD](#)
MIDDLE PENINSULA [FYI](#) [REGISTER](#) [SOLUTIONS](#) [INVESTMENTS](#)

Fight the Flood Business Registration

Participating Businesses

**40**

Alistair J. Ramsay L.S., P.C Land Surveying Services (AJR Surveying)
804-824-9374

ARRO Consulting, Inc.
717.686.4688

Atlantic Reefmaker
9199715641

Balzer & Associates
804-794-0571

Bay Design Group

Biogenic Solutions Consulting, LLC
804-815-0272

Bridge & Stream Engineering
719-488-9100

Building Resilient Solutions
7574072205

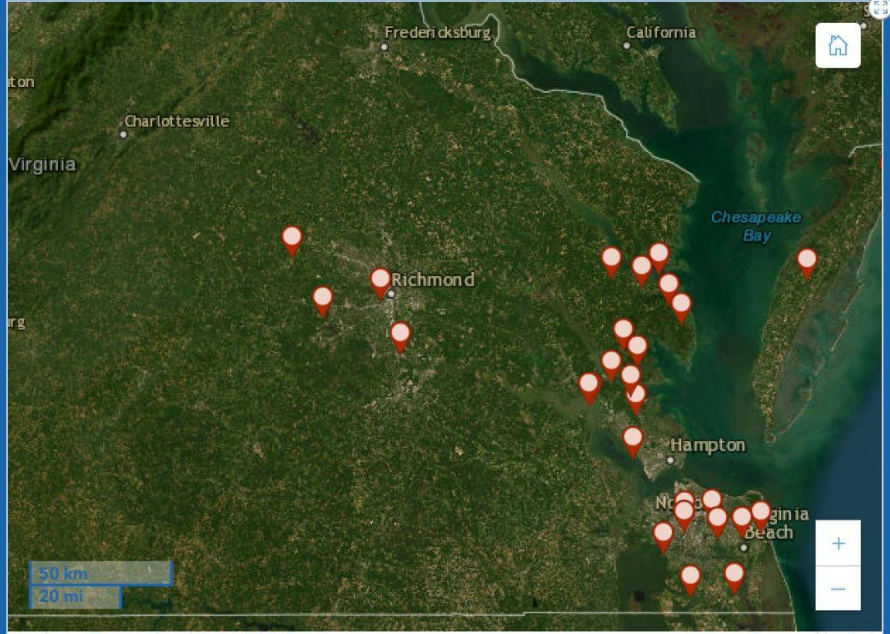

Earthstar Geographics | Esri, HERE, Garmin

Powered by Esri

Select an option in the list to the left or in the graph to the right to filter the associated businesses in the dashboard. Select the same option again to reset the filter. The map can be expanded by hovering over the map and selecting the icon in the top right above the home

Discounts Offered for Customers Referred by the Fight the Flood Program

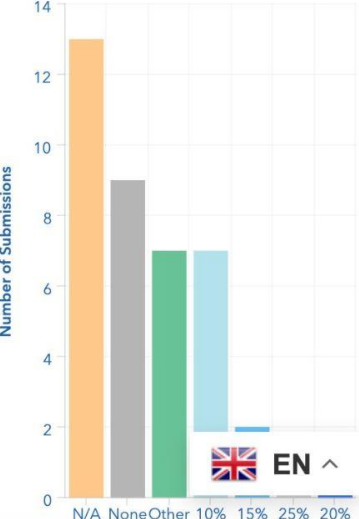

Discount Category	Number of Submissions
N/A	13
None	9
Other	7
10%	7
15%	2
25%	1
20%	1

EN ^

 **CHESAPEAKE BAY**
Landscape Professional

 **Living Shoreline Collaborative**

 **James River**
ASSOCIATION

A scenic view of a body of water, likely a lake or river, with tall reeds and grasses growing along the shoreline. In the background, a modern house with large windows and a balcony is visible, surrounded by trees. The water reflects the surrounding greenery and the sky.

Business Opportunities

Advise & Manage

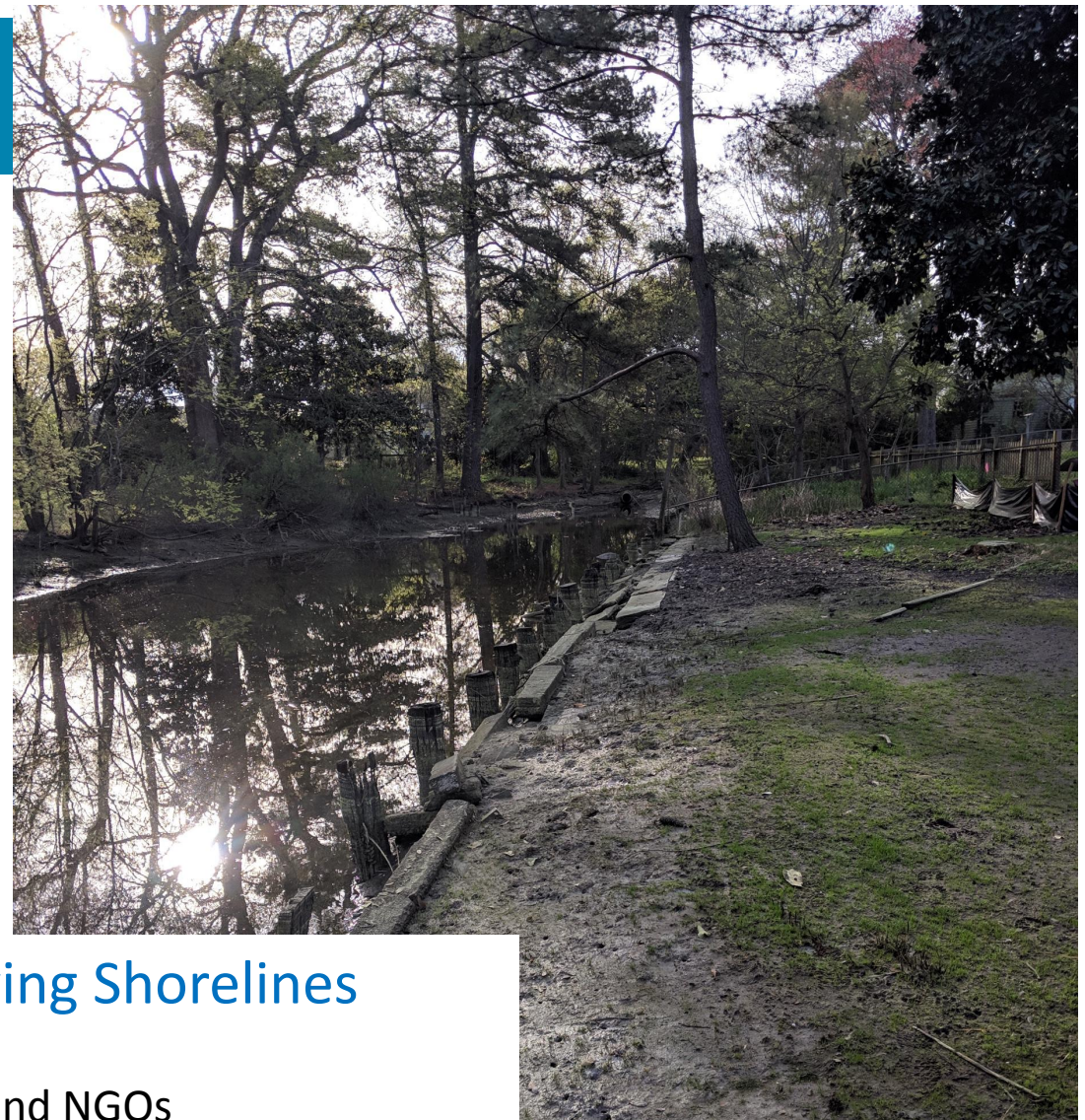

Evaluate the Site, Educate the Client, Recommend Living Shorelines

Look for need (failing bulkheads, eroding shorelines)

Vegetation assessment & management plan for shoreline contractors and NGOs

Sustainable and green infrastructure practices to reduce erosion (buffers, rain gardens, etc.)

Advise & Manage

ID best approach for your client & site

Research & connect with funding sources

Connect client with technical experts & subcontractors



Design, Drawings, Permitting

Start with low energy site
Partner with other pros

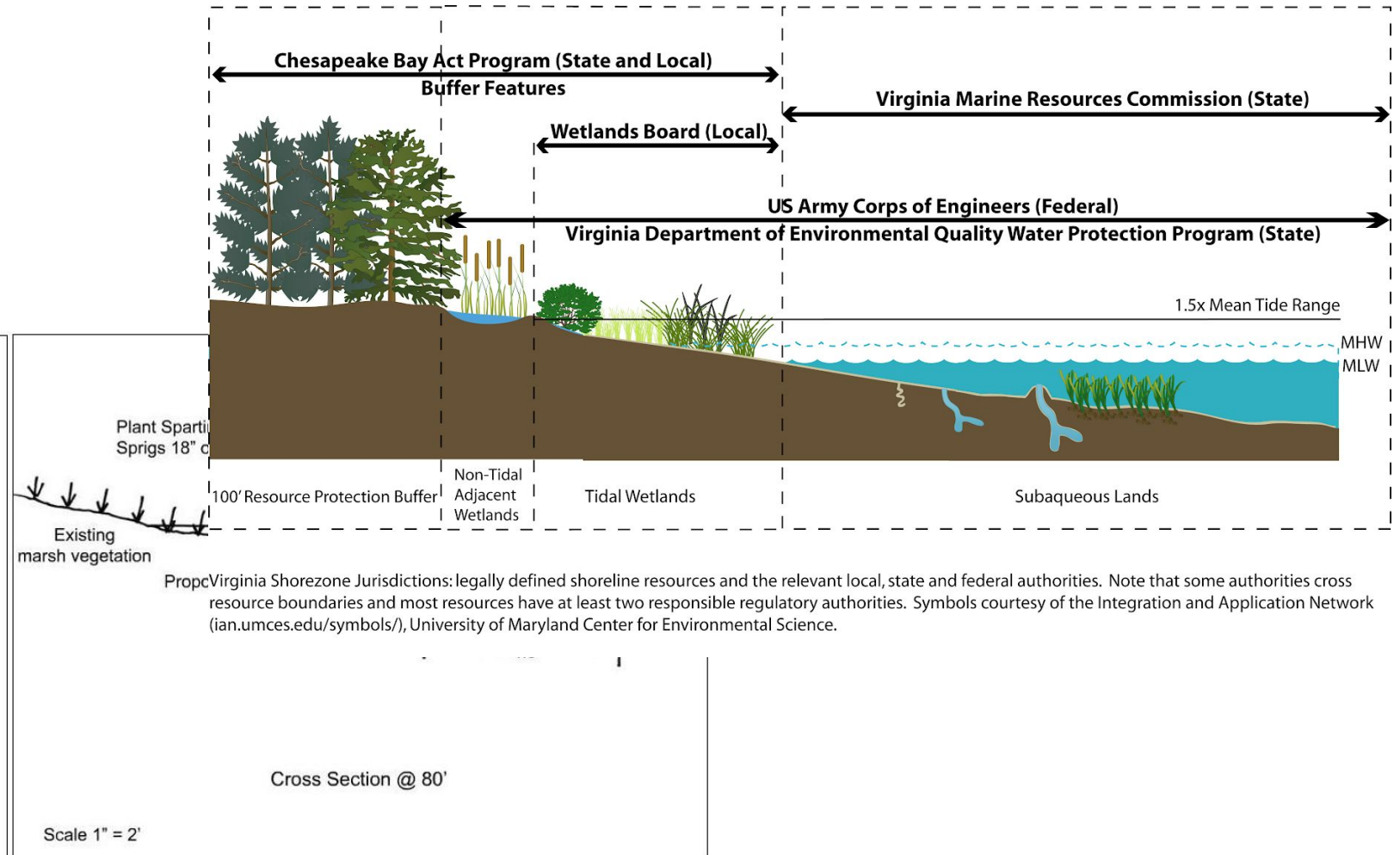
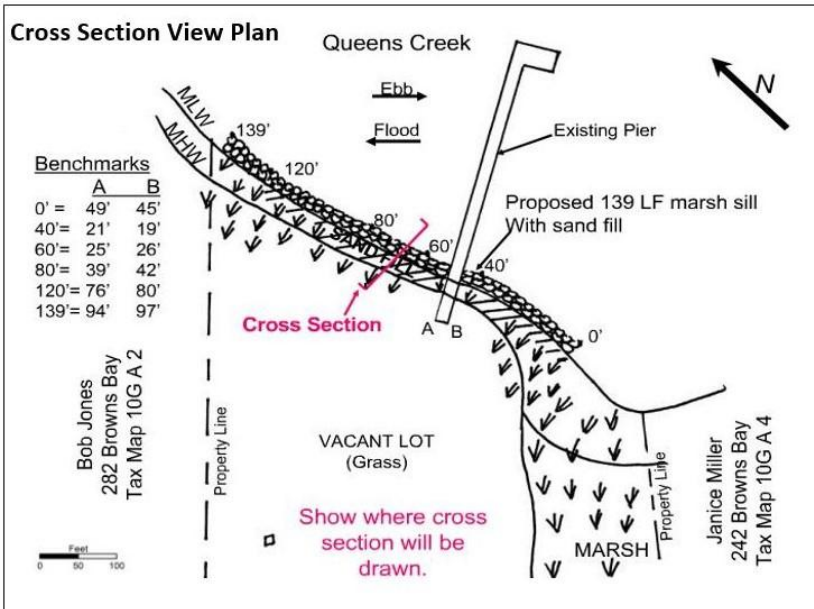

Planting Design



Glasswort
Has succule
with scale-li
4-20 inches
July to Nov



Marsh hibiscus
mallow - *Hibiscus moscheutos*
showy white
and alternat
up to 12 ft. a
to Septemb



Marsh mallard
virginica. Has
hibiscus-like
alternate lea
dense hairs
and blooms
August.

Detailed View



Salt Meadow Plants -
found in areas of periodic
inundation

Saltmeadow hay - *Spartina patens*. Leaves are in-rolled not 2-ranked with densely overlapping spikelets borne only one side of axis. It grows from 1-3 ft. and blooms from July to September.



Salt grass - *Distichlis spicata*. Has a terminal spike inflorescence and 2-ranked leaves. It grows 8-16 inches and blooms from July to September.



Sea lavender - *Limonium spp.* Has basal leaves and lavender flowers that bloom from July to October. Plant grows up to 3 ft.



Salt marsh aster - *Aster tenuifolius*. Has alternate, flexuous linear leaves and pale purple, blue or white daisy-like flowers that bloom



conspicuous white flowers in fall. Grows up to 8 ft and blooms from September to October.



Switch grass - *Panicum virgatum*. Has straw-colored panicle inflorescence. It grows up to 3 ft. and blooms from July to September.



Seaside goldenrod - *Solidago sempervirens*. Has dense clusters of yellow flowers and alternate lance-shaped leaves. It grows from 4-5 ft. and blooms from August to October.



Marsh elder - *Iva frutescens* - has opposite fleshy, lance-shaped toothed leaves, with small greenish white flowers that are not prominent. It grows 2-6 ft. and blooms in August to October.



CHESAPEAKE BAY
Landscape Professional

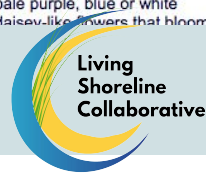

**Living
Shoreline
Collaborative**

Design

Enhance Water Views
Restore Buffer
Provide Access



Provide Materials, Labor, Equipment

- Plants
- Sand
- Coir logs
- Rock
- Fiber mats
- Goose fencing
- Wooden stakes
- E&S
- Site prep
- Aquatic pesticide applicator



Images: Elizabeth River Project & Bay Environmental

Monitor & Maintain



Images: Wetlands Watch
Elizabeth River Project's
River Star Homes Living Shorelines

Project Manager or Subcontractor

- Provide plans, ensure compliance and oversee implementation
- Manage contractors, consultants, permitting process
- Obtain permits/approval JPA, local wetlands and Chesapeake Bay boards
- Prepare site
 - Protect sensitive features
 - Establish construction staging & paths
 - Remove invasive species
- Lay out buffer and high marsh plantings
- Train maintenance people



Protect Sensitive Features During Construction

- Vegetation & Soil Protection - Exclusion Fencing
- Avoid soil compaction and tree root damage from vehicles & foot traffic – protect ground w/
 - 6-12" wood chips
 - ¾" thick plywood
 - 4x4" wood beams over 4"+ woodchips
 - 4-6" gravel over taut, staked geotextile fabric
 - Commercial logging or road mats on top of mulch layer.
- Make sure erosion control methods are in place and functioning at all times and remove when finished.



Image: Bay Environmental

Living Shoreline Outreach

Living Shorelines

Better for property owners and the environment:
Virginia's preferred approach for shoreline erosion management



VIMS | **WILLIAM & MARY**
VIRGINIA INSTITUTE OF MARINE SCIENCE
CENTER FOR COASTAL RESOURCES MANAGEMENT
... researching shorelines
for over fifty years



Living Shorelines

KEY REFERENCES:
VIRGINIA

How long does it take to grow a living shoreline?



IDEATION



Consider your site

- Are you interested in:
- erosion control?
- wildlife habitat?
- water quality?
- a natural appearance?
- coastal resilience?



Reach out

Contact the Living Shoreline Collaborative for more information or guidance. You can also find information about financial assistance through our website. Reaching out to contractors or landscape professionals early on means they can answer your questions from the outset and help you with permitting.



Permitting

It can take 3-5 weeks to gather the necessary information and put together your permit application. You can then expect a wait of 60-120 days or more for approval.

ON SITE

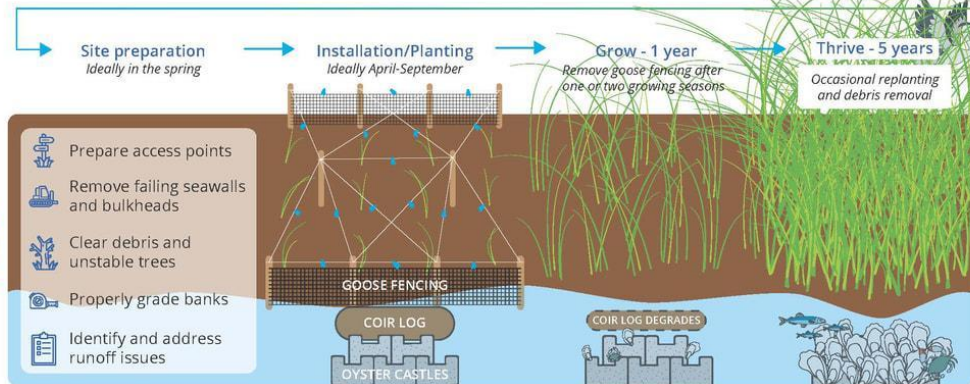

Note: Living shoreline designs start with plants and use biologically beneficial structures (like coir logs and oyster castles) as needed. Specific designs are dependent on the site or goal. For example, you can still have a strong, beautiful living shoreline in an area where oysters don't grow - you just wouldn't use oyster castles there.

Bay-Wide Resources
Tool Kit
Materials
Talking Points
Various Audiences

LIVING SHORELINE OUTREACH

Chesapeake Bay Program

IMPLEMENTATION PLAN



Professional Standards of Conduct, How to Find a Pro

[HOME](#) [GET CERTIFIED](#) [CBLP DIRECTORY](#) [LOG IN](#) 

Chesapeake Bay Landscape Professional Living Shoreline Training certificate (CBLP-Shorelines)



Living Shorelines for the Coastal Plain

For additional details or to access a list of professionals who have completed this course, please click on the orange buttons below.

[Learning Objectives](#) [Certificate Holders](#) [Contractor Questions](#)

Some things to think about regarding better business practices:

Do you have the proper licensure for your work?

Does your business have necessary insurance coverage?



Discussion: Building a *Community of Practice*

What does a Community of Practice look like?

How can we work together to implement and manage successful shoreline projects?

Quick Breakouts

Your Name

Affiliation

Living Shoreline Interest



Photo Source: Wetlands Watch
Living Shoreline by:

